

HORIBA

Explore the future

OIL CONTENT ANALYZER OCMA-350

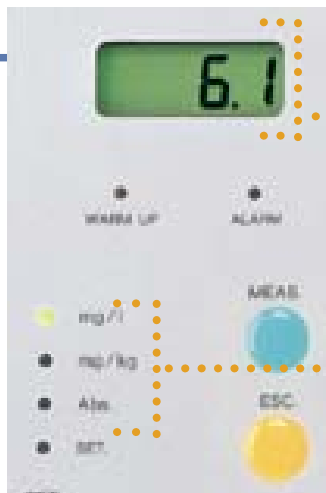



Easy-to-read backlit LCD

The backlit LCD is easy to read under any conditions, including bright sunlight. The digital display eliminates individual reading differences.

Three measurement units

The OCMA-350 measures in mg/l for oil in water, mg/kg for oil in soil, and Abs. for the absorbency of oil, so you can always choose the proper unit for your sample measurement.

Cell control

To introduce your sample into the removable cell, just pull the cell out of its holder. It's easy to avoid leaks and spills when you have this much control. The removable cell is also easy to maintain.



Plug it in, and it's on stand-by. The press of just one button starts the measuring process. You can even use your PC to simplify operation.

Pushbutton simplicity, perfect for field

Compact and simple, HORIBA's OCMA-350 oil content analyzer delivers quick, accurate measurements in the lab or in the field. It efficiently measures the level of oil in water or soil for environmental applications, checks for residual oil on semiconductor parts which have been cleaned, and measures oil on any industrial surface.

Using the OCMA-350 is almost effortless. Simply inject the extract from your sample, dissolved in Horiba's S-316 solvent, into the measuring cell, and press one button. You can even use your PC to simplify operation.

Recommended Applications

- Environment: Surveying water quality and hazardous waste sites
- Industry: Monitoring wastewater influent and effluent
- Marine transportation: Checking bilge and ballast discharge
- Petroleum processing: Monitoring the efficiency of oil/water separation processes
- Oil depots: Monitoring the discharge produced when cleaning storage tanks
- Automotive: Monitoring waste-water discharge from service stations
- Quality Assurance: Measuring residual oil on textiles and metal parts.

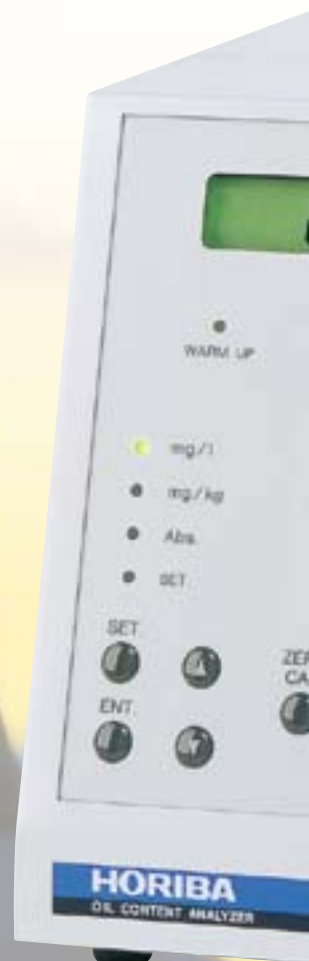

All the right connections

Each unit is equipped with a printer port and an RS-232C port. Simply connect the OCMA-350 to your printer or PC for remote control of the unit and ready access to measurement data.



The OCMA-350 has various special features to assure accurate measurements.

Stable readout

The unit's data evaluation function analyzes the readings, determines when the value has stabilized, and displays that stable value.

Self-monitoring

Messages on the LCD screen inform you of any electrical malfunctions, irregularities in measurement, and deterioration of parts, so that you can always be assured of proper functioning.

Simplified recordkeeping

The OCMA-350 keeps a record of the time and date of measurement along with each



Measurement of residual oil

The OCMA-350 makes it easy to measure residual oil on pre-cleaned parts.

1 Choose a reasonably sized sample

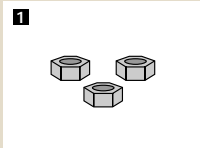

2 Measure out an appropriate amount of solvent, and immerse the parts in the solvent until all the residual oil has dissolved.

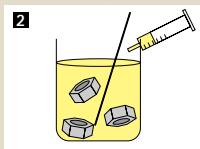

3 Introduce the resulting solution to the measuring cell, and set the cell in place.

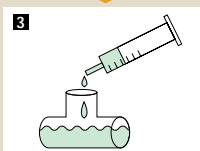

4 Press the start button and wait for the results.

HORIBA's S-316 Solvent

The OCMA-350 uses the highly effective, environmentally-safe S-316 extraction solvent to extract the oil components from oily water samples, soil samples, or product surfaces. The extract is analyzed using IR absorbance, a non-dispersive infrared spectrophotometric technique which is specific to hydrocarbons such as oil.

The OCMA-350 measures absorption in the 3.4 to 3.5 micrometer range. The two graphs at the right show the absorption spectra of (1) petroleum and (2) HORIBA's S-316 solvent. All hydrocarbons, including oils, absorb infrared radiation at about 3.4 to 3.5 micrometers. As a result, the unit can measure any hydrocarbons in the extraction solvent quickly and accurately, with no distortion of values due to the presence of the solvent.

HORIBA's S-316 Solvent can be recycled with the aid of the optional SR-300 Solvent Reclaimer. Recycling the solvent not only cuts your solvent costs, but also helps protect the environment.

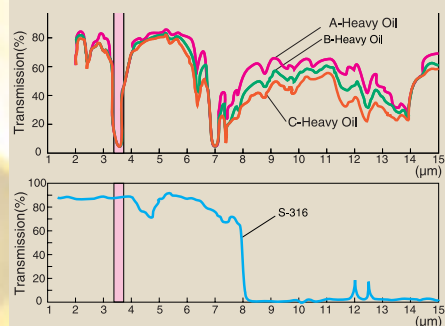
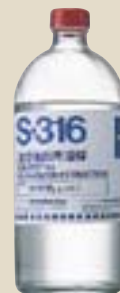

Dimensional Outlines

Unit: mm

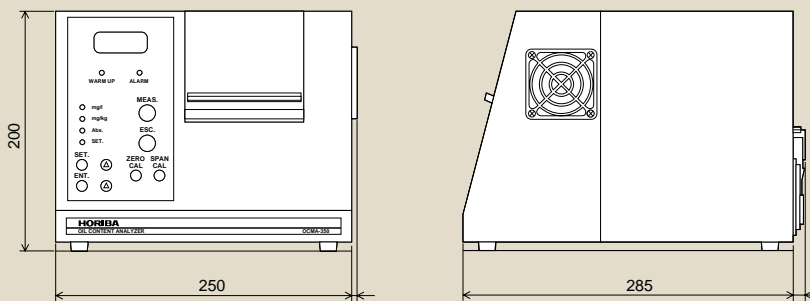

Specifications

Application: Oil contamination of fresh and salt water; soil analysis

Principle: Solvent extraction, NDIR analysis (infrared spectroscopy)

Detector: Pyroelectric sensor

Cell: Quartz cell, cell length 20 mm

Measuring range and unit: 0 to 200 mg/L, 0 to 1000 mg/kg, 0 to 1 Abs.

Resolution:

mg/L; 0 to 99.9 mg/L; 0.1 mg/L

100 to 200 mg/L; 1 mg/L

mg/kg; 0 to 9.99 mg/kg; 0.01 mg/kg

10.0 to 99.9 mg/kg; 0.1 mg/kg

100 to 1000 mg/kg; 1 mg/kg

Abs; 0 to 1000 Abs; 0.001 Abs

Repeatability:

mg/L; 0 to 9.9 mg/L; ± 0.4 mg/L ± 1 digit

10.0 to 99.9 mg/L; ± 2.0 mg/L ± 1 digit

100 to 200 mg/L; ± 4 mg/L ± 1 digit

Abs; $\pm 1\%$ of full scale

Measurement: Manually controlled

Calibration: Automatic calibration after the calibration standard is introduced to the instrument

Extraction solvent: HORIBA S-316 solvent (Standard 3 accessories)

use only S-316, not other solvent

Sample/solvent volume: Approx. 6.5 mL, ratio of sample to solvent is 1:1

Display: Measured value; 3 1/2 digits LCD with back-light

Message; Character display LCD with back-light (16 x 2 characters)

Functions: Self diagnostics, Auto hold function, Calendar clock

Output: RS-232C and centronics printer port

Ambient temperature: 0 to 40°C

Power requirement: 100 to 240 V AC $\pm 10\%$, 50/60 Hz, 60 VA

Dimensions: 200 (H) x 250 (W) x 285 (D) mm

Weight: Approx. 5 kg

Model SR-300 Solvent Reclaimer (optional)

Highly efficient, the SR-300 solvent reclaimer can reduce your per test solvent cost by up to 90%. This optional unit, designed especially for reclaiming HORIBA's S-316 solvent, features a double column of activated carbon and activated aluminum. It has a large filtering capacity, is easy to operate, and requires no electricity.

External dimensions:

200 (W) X 200 (D) X 600 (H) mm



Horiba continues contributing to the preservation of the global environment through analysis and measuring technology.



Please read the operation manual before using this product to assure safe and proper handling of the product.

- The contents of this catalog are subject to change without prior notice, and without any subsequent liability to this company.
- The color of the actual products may differ from the color pictured in this catalog due to printing limitations.
- It is strictly forbidden to copy the content of this catalog in part or in full.

HORIBA

<http://www.horiba.com> e-mail: info@horiba.co.jp

● HORIBA, Ltd.

Head Office
Miyano Higashi, Kisshoin
Minami-ku, Kyoto, Japan
Phone: 81 (75) 313-8123
Fax: 81 (75) 321-5725

Tokyo Sales Office
1-7-8 Higashi-Kanda
Chiyoda-ku, Tokyo, Japan
Phone: 81 (3) 3861-8231
Fax: 81 (3) 3861-8259

Beijing Representative Office
Suite 1409, Tower B,
COFCO Plaza, No. 8,
Jianguomennei Avenue,
Beijing, China, 100005
Phone: 86 10-6522-7573
Fax: 86 10-6522-7582

Shanghai Representative Office
Unit F1 16F
Jiushi Fuxing Mansion,
No. 918, Huaihai Zhong Road,
Shanghai, China, 200020
Phone: 86 21-6415-3889/90
Fax: 86 21-6415-9746

Taiwan Representative Office
No. 15 Alley 6, Lane 485,
Sec. 1, Kuang Fu Rd.,
Hsin-Chu, Taiwan, R.O.C.
Phone: 886 (3) 5799143
Fax: 886 (3) 5799164

● HORIBA KOREA Ltd.

112-6 Sogong-Dong
Choong-ku, Seoul, Korea
Phone: 82 (2) 753-7911
Fax: 82 (2) 756-4972

● HORIBA INSTRUMENTS Pte. LTD.

10 Ubi Crescent
#05-11/12, Ubi Techpark
Singapore 408564
Phone: 65 6745-8300
Fax: 65 6745-8155

● HORIBA INSTRUMENTS INCORPORATED

Irvine Facility
17671 Armstrong Avenue
Irvine, CA 92614, U.S.A.
Phone: 1 (949) 250-4811
Fax: 1 (949) 250-0924

Ann Arbor Facility
5900 Hines Drive
Ann Arbor, MI 48108
U.S.A.
Phone: 1 (734) 213-6555
Fax: 1 (734) 213-6525

HORIBA / STEC INCORPORATED
1080 E. Duane, Suite. A
Sunnyvale, CA 94086
U.S.A.
Phone: 1 (408) 730-4772
Fax: 1 (408) 730-8975

● HORIBA GmbH

Kaplanstrasse 5
A-3430 Tulln,
Austria
Phone: 43 (2272) 65225
Fax: 43 (2272) 65230

HORIBA CZECHIA
Organizace slozka Praha
Petrohradská 13
CZ-101 00 Praha 10, Czech Republic
Phone: 420 (2) 717-464-80
Fax: 420 (2) 717-470-64

● HORIBA INSTRUMENTS LIMITED

Kyoto Close
Summerhouse Road
Moulton Park, Northampton
NN3 6FL, U.K.
Phone: 44 (1604) 542500
Fax: 44 (1604) 542699

● HORIBA EUROPE GmbH

Head Office
Hauptstrasse 108
D-65843 Sulzbach
Germany
Phone: 49 (6196) 6718-0
Fax: 49 (6196) 641198

Leichlingen Facility
Julius-kronenberg Strasse
D-42799 Leichlingen
Germany
Phone: 49 (2175) 8978-0
Fax: 49 (2175) 8978-50

HORIBA FRANCE
Rue L. et A. Lumière
Technoparc
F-01630 St-Genis-Pouilly
France
Phone: 33 (4) 50-42-27-63
Fax: 33 (4) 50-42-07-74

HORIBA SWEDEN
Hertig Carlsväg 55-57
S-15138 Södertälje
Sweden
Phone: 46 (8) 550-80701
Fax: 46 (8) 550-80567

HORIBA ITALY
Europalace
Corso Torino 43/45
10043 Orbassano, Torino, Italy
Phone: 39 (011) 9040601
Fax: 39 (011) 9000448