

HORIBA

Explore the future

Harmful Element Fluorescence X-ray Inspection Instrument

XGT-1000WR

Compliant with WEEE and RoHS Directives

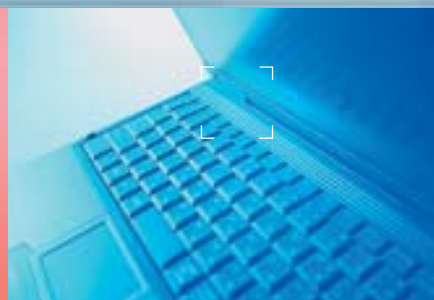
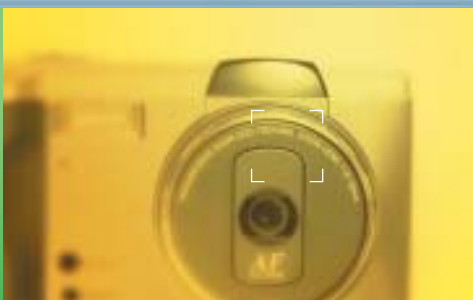

Proposals from the XGT Series



1.



▶ Simply place the sample directly into the sample chamber. The X-ray irradiation diameter is 1.2 mm, so even small parts can be measured as is. The XGT series makes it easy for anyone to perform precise measurements.

2.



▶ The area to be tested can be specified easily, even for parts with multiple plastic sections, by observing the sample using the 50X CCD camera.

▶ The XGT provides greater X-ray intensity. That is the secret to the high-precision analysis and quick analysis of the XGT Series.

The XGT series uses an X-ray guide tube (XGT)!

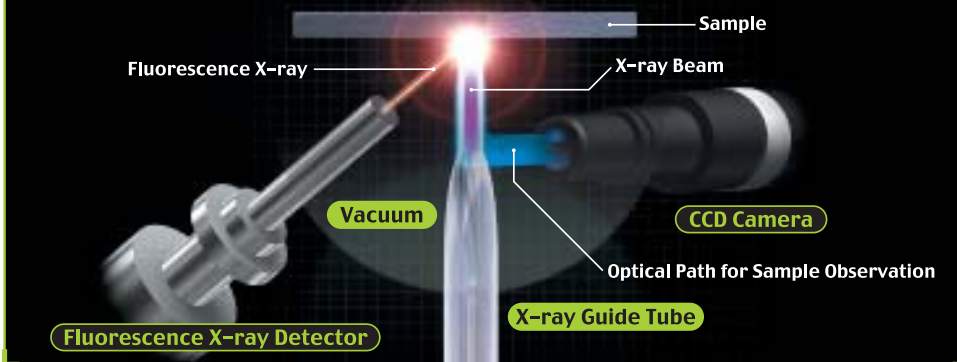

The XGT-1000WR employs HORIBA's original X-ray beam condensation technology and use a narrow and high-intensity X-ray beam method. This provides shorter measurement time and higher precision than methods using an X-ray collimator. Furthermore, the X-ray detector uses a high-purity Si detector, the only one of its type in the world, which provides superb long-term stability.

With the 0.1 mm diameter X-ray guide tube capable of simultaneously measuring multiple elements (Na to U), the XGT-1000WR can also be used as a point element analyzer of normal XRF (TYPE II).

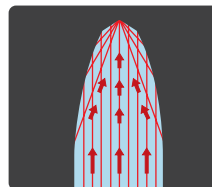

▶ Fast analysis startup —there is no need to set a vacuum in the sample chamber.

▶ Available with a wide range of sample sizes, from small parts to large products.

The combination of a large sample chamber and 1.2 mm diameter X-ray beam provides availability with a wide range of sample sizes, from small parts to large products (sample chamber interior: 460 x 360 x 150 mm). The advanced optical design makes it possible to arrange the CCD monitoring axis and the X-ray beam co-axial, providing parallax-free measurements, even for samples with stereo shape.

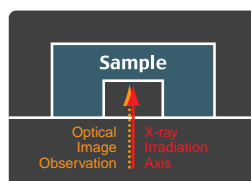

XGT-1000WR Co-axial Observation

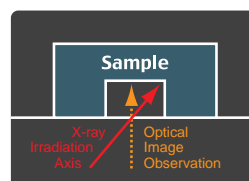

Non-Co-axial Observation



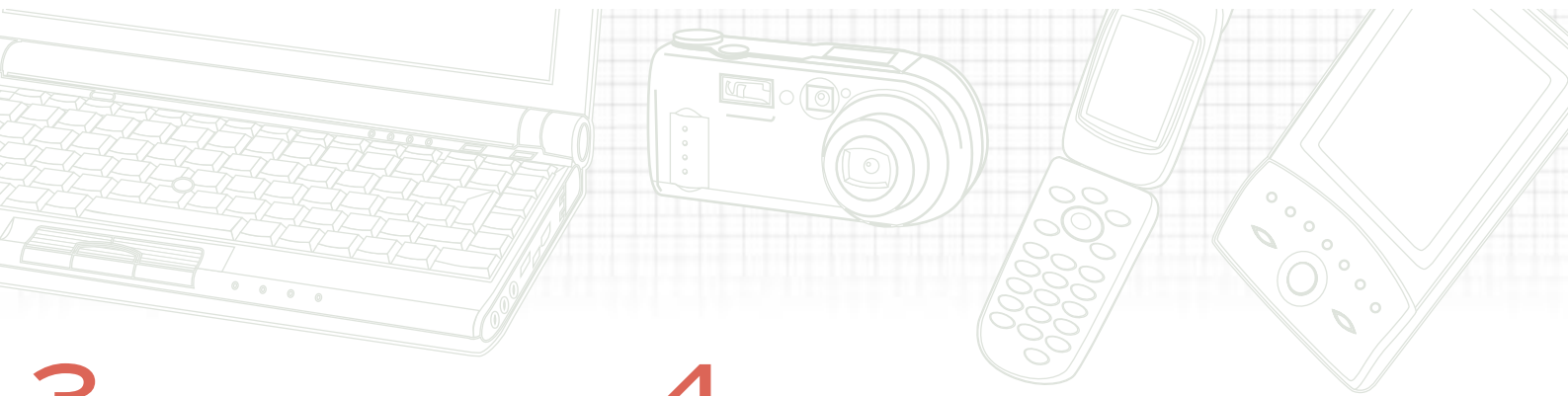

3.



▶ Just press the button to perform the analysis automatically.

4.

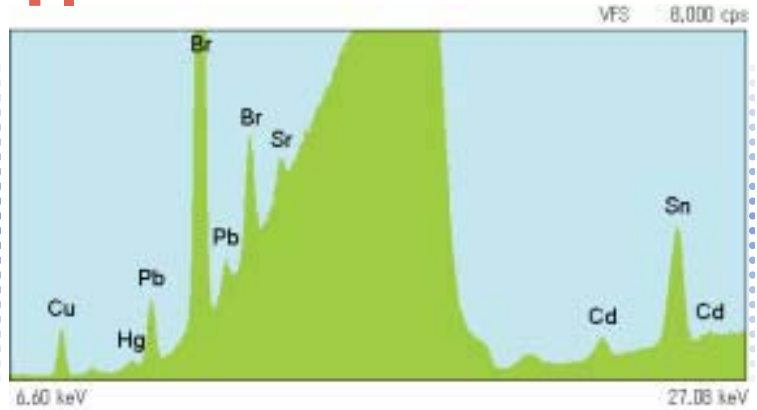

▶ The analysis results are displayed quickly and accurately.

▶ The result of the incorporation of numerous original HORIBA technologies.

Lower Detection Limits

Cd 2 ppm Pb 5 ppm

Compliant with WEEE and RoHS Directives

Directive based on EC175 promoting the separate collection of electrical and electronic equipment as well as their recycling and recovery. Individual countries in the EU may also enact their own stricter domestic policies.

Directive based on EC95 prohibiting the use of six substances -- lead, mercury, cadmium, hexavalent chromium, polybrominated biphenyl (PBB), and polybrominated diphenylether (PBDE), contained in electrical and electronic equipment. Electric equipment parts require individual checking as these substances are often added to plastics to increase flame resistance.

▶ **Industries and products covered by WEEE and RoHS include:**

From the "List of Products Covered by the RoHS Directive"

- Large household appliances
- Small household appliances
- IT and telecommunications equipment
- Consumer equipment
- Lighting Equipment
- Electrical and electronic tool
- Toys, leisure and sports equipment
- Automatic dispensers



XGT-1000WR		Type I	Type II
Measurement Principle		Energy Dispersive Fluorescence X-ray Analysis Method	
Elements Measured		Si to U (Cd/Pb high-sensitivity model)	1.2 mm probe: Si to U 0.1 mm probe: Na to U (When selecting the 1.2 mm/0.1 mm diameter switching method)
Lower Detection Limit (Cd/Pb)		Cd 2 ppm, Pb 5 ppm	1.2 mm probe: Cd 2 ppm, Pb 5 ppm
X-ray Radiation Diameter		1.2 mm	1.2 mm/0.1mm
Sample Shape		Maximum Size: 460 X 360 mm (height: 150 mm)	
Sample Chamber Atmosphere		Normal Atmospheric Pressure	
X-ray Tube	Target	Rh	
	Tube Voltage	50 kV max.	
	Tube Current	1 mA max.	
Detector		XEROPHY High-Purity Si Detector	
Dewar Capacity		3 liters	
Liquid Nitrogen Consumption		1 liter or less per day (no replenishment needed during storage)	
Optical Image Observation		approx. 50X magnification (coaxial observation with the X-ray axis)	
Software		Qualitative Analysis: Automatic or Manual Qualitative Analysis	
		Quantitative Analysis: Calibration Curve Method (When Using 0.1 mm Irradiation Diameter: Fundamental Parameter Methods 1. Standardless, 2. 1-Point Calibration)	
		User-Settable Functions: A sequence of operations from measurement to quantitative analysis can be performed in accordance with preset conditions entered by the user.	
Computer	CPU	Pentium IV 1.8 GHz or faster	
	Memory	256 MB or more	
	Hard disk	20 GB or larger	
	OS	Windows XP	
Display		17 in. CRT monitor (option: 17 in. LCD monitor)	
Printer		Color Inkjet Printer	
Ambient Temperature		10°C to 35°C (optimum performance temperature) 5°C to 40°C (operating temperature)	
Ambient Humidity		Humidity Range from 5°C to 31°C: 80% maximum relative humidity Humidity Range from 31°C to 40°C: linear decrease to 50% relative humidity	
Electric Power Supply		AC 100 V, 120 V, 220 V, 240 V 10%, 50/60 Hz	
Electric Power Consumption		1.3 kVA or less (including computer, CRT and printer)	
System Weight		approx. 265 kg (including stand and computer)	
External Dimensions	Analyzing Unit	610 W 750 D 500 H mm	
	Signal Processing Unit	220 W 500 D 480 H mm	

The XGT Series is a series of devices successfully developed with the technological support of the National Institute for Materials Science through the development consignment system of the Japan Science Technology Corporation.

Patents: 1699838, 1806535, 1828290, 1866194, 2032556, 2032557

Horiba continues contributing to the preservation of the global environment through analysis and measuring technology.

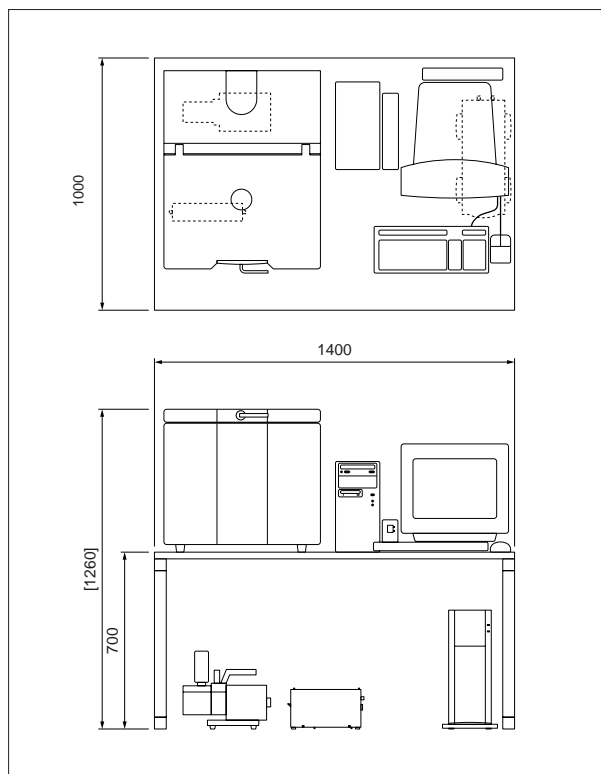

The system layout can be arranged in a variety of ways to meet your application needs.



Please read the operation manual before using this product to assure safe and proper handling of the product.

- The contents of this catalog are subject to change without prior notice, and without any subsequent liability to this company.
- The color of the actual products may differ from the color pictured in this catalog due to printing limitations.
- It is strictly forbidden to copy the content of this catalog in part or in full.

HORIBA

<http://www.horiba.com> e-mail: info@horiba.co.jp



HORIBA 50 years

Explore the future - 2003

● **HORIBA, Ltd.**

Head Office
Miyano Higashi, Kisshoin
Minami-ku, Kyoto, Japan
Phone: 81 (75) 313-8123
Fax: 81 (75) 321-5725

Tokyo Sales Office
1-7-8 Higashi-Kanda
Chiyoda-ku, Tokyo, Japan
Phone: 81 (3) 3861-8231
Fax: 81 (3) 3861-8259

Beijing Representative Office
Suite 1409, Tower B,
COFCO Plaza, No. 8,
Jianguomennei Avenue,
Beijing, China, 100005
Phone: 86 10-6522-7573
Fax: 86 10-6522-7582

Shanghai Representative Office
Unit F1 16F
Jiushi Fuxing Mansion,
No. 918, Huaihai Zhong Road,
Shanghai, China, 200020
Phone: 86 21-6415-3689/90
Fax: 86 21-6415-9746

Taiwan Representative Office
No.15 Alley6, Lane 485,
Sec. 1, Kuang Fu Rd.,
Hsin-Chu, Taiwan, R.O.C.
Phone: 886 (3) 5799143
Fax: 886 (3) 5799164

● **HORIBA KOREA Ltd.**
112-6 Sogong-Dong
Choong-ku, Seoul, Korea
Phone: 82 (2) 753-7911
Fax: 82 (2) 756-4972

● **HORIBA INSTRUMENTS Pte. LTD.**

10 Ubi Crescent
#05-11/12, Ubi Techpark
Singapore 408564
Phone: 65 6745-8300
Fax: 65 6745-8155

● **HORIBA INSTRUMENTS INCORPORATED**

Irvine Facility
17671 Armstrong Avenue
Irvine, CA 92614, U.S.A.
Phone: 1 (949) 250-4811
Fax: 1 (949) 250-0924

Ann Arbor Facility
5900 Hines Drive
Ann Arbor, MI 48108
U.S.A.
Phone: 1 (734) 213-6555
Fax: 1 (734) 213-6525

● **HORIBA / STEC INCORPORATED**
1080 E. Duane, Suite. A
Sunnyvale, CA 94086
U.S.A.
Phone: 1 (408) 730-4772
Fax: 1 (408) 730-8975

● **HORIBA GmbH**
Kaplanstrasse 5
A-3430 Tulln,
Austria
Phone: 43 (2272) 65225
Fax: 43 (2272) 65230

HORIBA CZECHIA
Organizacni slozka Praha
Petrohradská 13
CZ-101 00 Praha 10, Czech Republic
Phone: 420 (2) 717-464-80
Fax: 420 (2) 717-470-64

● **HORIBA INSTRUMENTS LIMITED**

Kyoto Close
Summerhouse Road
Moulton Park, Northampton
NN3 6FL, U.K.
Phone: 44 (1604) 542500
Fax: 44 (1604) 542699

● **HORIBA EUROPE GmbH**

Head Office
Hauptstrasse 108
D-65843 Sulzbach
Germany
Phone: 49 (6196) 6718-0
Fax: 49 (6196) 641198

Leichlingen Facility
Julius-kronenberg Strasse
D-42799 Leichlingen
Germany
Phone: 49 (2175) 8978-0
Fax: 49 (2175) 8978-50

HORIBA FRANCE
Rue L. et A. Lumière
Technoparc
F-01630 St-Genis-Pouilly
France
Phone: 33 (4) 50-42-27-63
Fax: 33 (4) 50-42-07-74

HORIBA SWEDEN
Hertig Carlsväg 55-57
S-15138 Södertälje
Sweden
Phone: 46 (8) 550-80701
Fax: 46 (8) 550-80567

HORIBA ITALY
Europalace
Corso Torino 43/45
10043 Orbassano, Torino, Italy
Phone: 39 (011) 9040601
Fax: 39 (011) 9000448

Bulletin:HRE-3903A

Printed in Japan ZM-M(SK)13