

## Quick Manual

Portable pH Meter D-73/D-74/D-75



<http://www.horiba-water.com>

**HORIBA**  
Scientific

CODE:GZ0000336673  
August, 2013 © 2013 HORIBA, Ltd.

## Preparation

pH measurement

### ① Prepare pH standard solutions

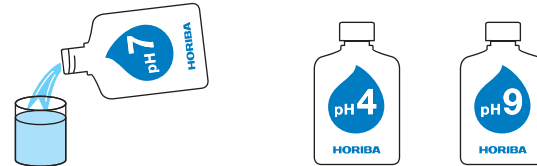

### ② Connect the electrode to the meter

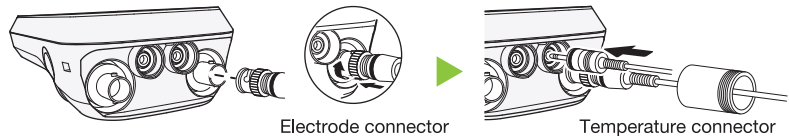

### ③ Press the power key of the meter

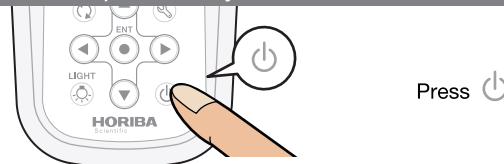

### ④ Remove the protective cap from the electrode, and open the internal solution filler port

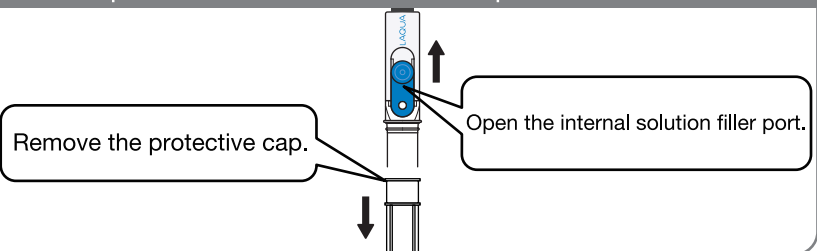

※Illustration is image of D-74

# Calibration

When the measurement sample is known to be acidic, perform two-point calibration with pH7 and pH4.  
When it is known to be alkaline, perform two-point calibration with pH7 and pH9.  
When the sample pH is not known, perform three-point calibration with pH4, pH7 and pH9.

## ① Enter the calibration mode

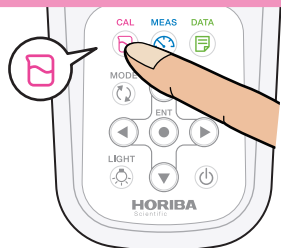

Press

## ② Start the first point calibration

Immerse the electrode in the pH7 standard solution until the liquid junction is fully submerged.

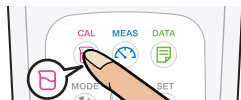

Immerse 3 cm or more.

Confirm that the instantaneous value is stable, then press .



When **HOLD** changes from the blinking state to the lit state and **7** appears, calibration is complete.

When performing the second point calibration, press .

To measurement or second point calibration

## ③ Start the second point calibration

Immerse the electrode in the pH4 standard solution until the liquid junction is fully submerged.

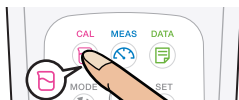

Immerse 3 cm or more.

Confirm that the instantaneous value is stable, then press .



When **HOLD** changes from the blinking state to the lit state and **4** appears, calibration is complete.

When performing the third point calibration, press .

To measurement or third point calibration

## ④ Start the third point calibration

Immerse the electrode in the pH9 standard solution until the liquid junction is fully submerged.

※The calibration method is the same as first and second point calibration.

When **HOLD** changes from the blinking state to the lit state and **9** appears, calibration is complete.

To measurement

# Measurement

## ① Enter the measurement mode

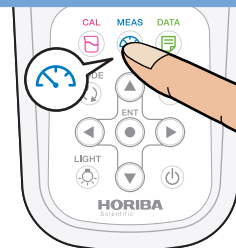

Press

## ② Start the measurement



Immerse 3 cm or more.

Press



When **HOLD** changes from the blinking state to the lit state, measurement is complete.

### NOTE

When the batteries run out or the instrument will not be used for a long time, remove the batteries.